

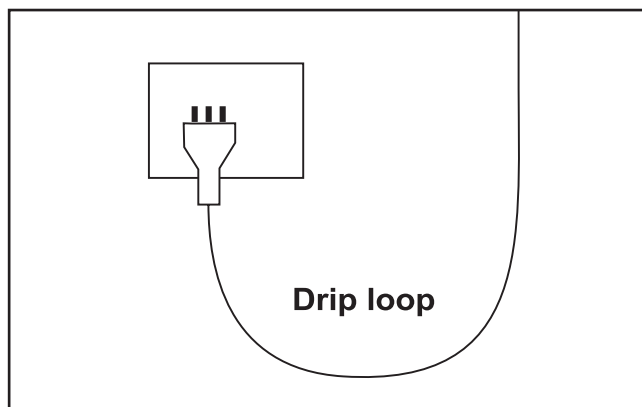

# Important Safeguards

**To guard against injury, basic safety precautions should be observed, including the following:**

1. Read and follow all safety instructions and important notices in these instructions as well as on the product itself.
2. This appliance is not intended for use by children or infirm persons without supervision. Young children should be supervised to ensure that they do not play with the appliance.
3. To avoid possible electric shocks, special care should be taken since water is employed in the use of aquarium equipment. For each of the following situations do not attempt repairs yourself. Return the appliance to an authorised service facility for service or discard the appliance.
  - a. If the appliance or any electrical component of the appliance (non-immersible equipment only) falls into the water or gets wet, do not reach for it. Unplug it and then retrieve it.
  - b. If the appliance shows any sign of abnormal water leakage, immediately unplug it from the power source.
  - c. Carefully examine the appliance after installation. It should not be plugged in if there is water on parts which are not intended to be wet.
  - d. Do not operate the appliance if it has a damaged cord or plug, or if it is malfunctioning, or dropped or damaged in any manner.
4. A "drip loop" (see graphic) should be arranged for each cable connecting an aquarium to a power supply. The drip loop is the part of the cable below the level of the power supply. It prevents water travelling down the cable and coming into contact with the power supply. If the plug or the socket does get wet, do not unplug the appliance. Disconnect the fuse or circuit breaker that supplies the power to the appliance, then unplug and examine for presence of water in the socket.
5. Always unplug the appliance from the electrical outlet when not in use, before putting on or taking off parts, before any type of maintenance or cleaning.
6. Never yank the cable to pull it from the socket. Pull the plug carefully to disconnect.
7. Do not use the appliance for reasons other than the intended use. The use of attachments that are not recommended or sold by the manufacturer may cause the product to be unsafe. This is not recommended.
8. Do not install or store the appliance where it will be exposed to weather or temperatures below freezing.
9. Make sure any component mounted on a tank is securely installed before operating it.
10. Ensure input voltage is the same voltage as your local power supply.
11. If an extension cable is used it should have the proper rating. Care should be taken to arrange the cord so that it will not be tripped or pulled.
12. A G.F.C.I (Ground fault circuit interrupter) & surge protector is recommended for all electrical appliances.
13. Ensure your hands are dry when turning the power switch on/off and when inserting/removing the power cable from the socket.
14. If you are in any doubt about the electrical installation or safety of this product you must consult a qualified electrician.



**For Guarantee Conditions, please refer to the Guarantee form that is enclosed with this product.**

All products are supplied with fitted plugs. This plug should not be tampered with in any way or removed. Removal or tampering with the plug invalidates our guarantee offered with this product.

For UK a 3 pin adaptor is supplied with the product and this must be used.

# Before First Use / Preparation

Read and follow all the instructions, even if you feel you are familiar with the product and find a place to keep the instructions handy for future reference. Your attention is drawn particularly to the sections concerning **“IMPORTANT SAFEGUARDS”** and the **“GUARANTEE CONDITIONS”**. Please ensure you retain your original purchase receipt in the event that guarantee service is required.

This product is shipped to you in a factory sealed carton. Should the product malfunction in any way or if the unit is damaged and requires replacement, contact the retailer where the product was purchased for inspection.

Carefully unpack the product making sure you keep all the packing material until all the parts of the product have been found and the product has been assembled.

## Correct Positioning in Aquarium

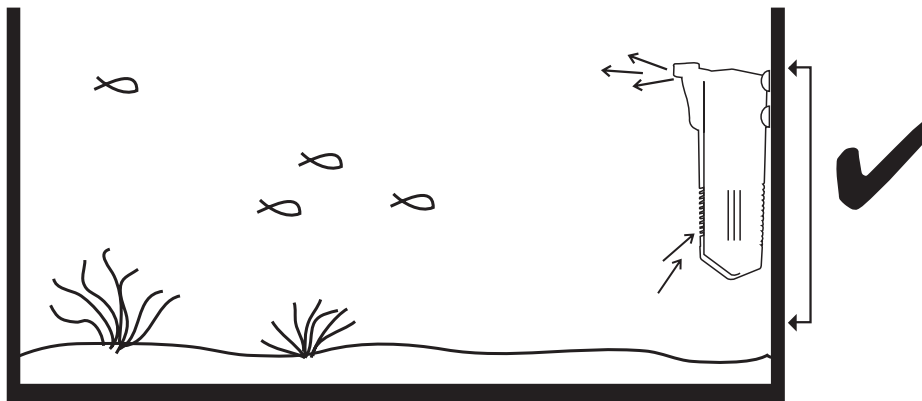

Set the filter up within the arrows indicated above.

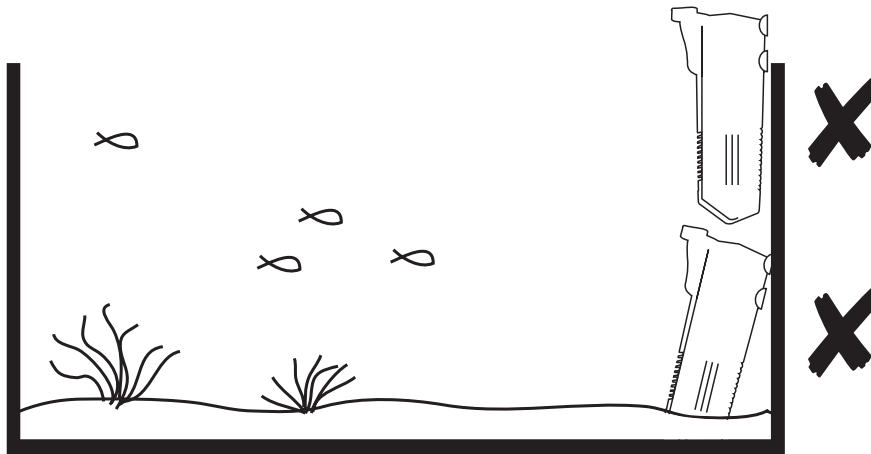

Filter must not be out of the water and must not be in contact with any substrate.

# Know Your Filter 101F & 102F

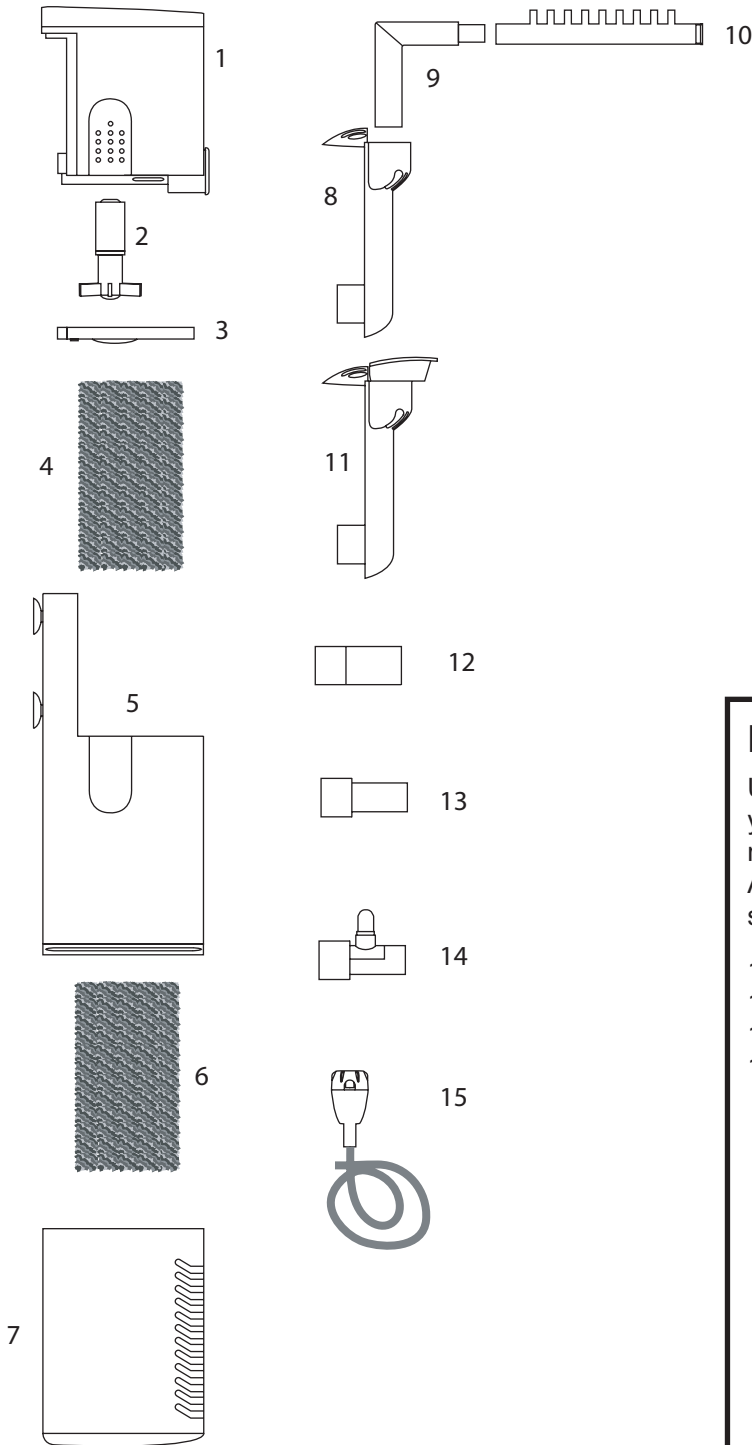

1. Motor
2. Impeller
3. Impeller Cover
4. Sponge
5. Top Sponge Casing
6. Sponge (102F Only)
7. Bottom Sponge Casing (102F Only)
8. Spray bar outlet
9. Elbow
10. Spray Bar
11. Duck Bill Outlet
12. 13mm Outlet
13. 9mm Outlet
14. Venturi Outlet
15. Venturi & Air Line

## Replacement Parts & Filter Media

Use Aqua One Genuine Spare Parts Only. See your local Aqua One Dealer and look for the number listed below for the spare part you require. Alternatively you will find these numbers on the silver label located on the product.

101F Maxi Sponge	25S
101F Maxi Impeller	11
102F Maxi Sponge	26S
102F Maxi Impeller	26I

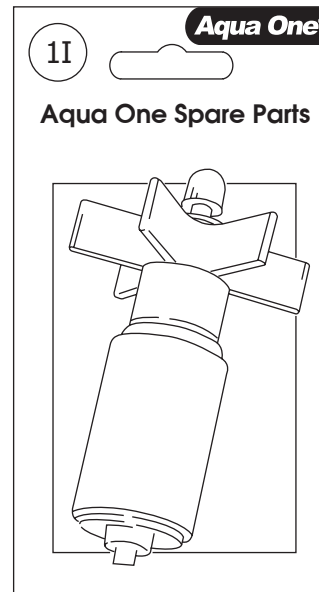

# Installation 101/102F

The larger models have two sponges for additional filtration but still in most cases these models should only be used as a secondary filter to help with existing filtration or as extra water flow in the aquarium.

They are fully assembled and ready to use.

1. Decide on which outlet option to use.

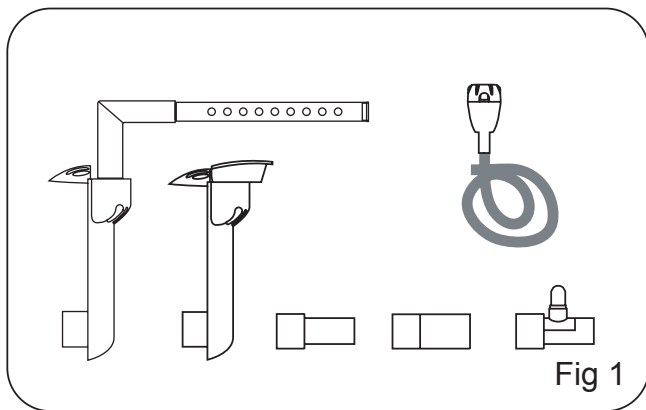

a) If no attachment is required simply push the direct outlet or reducer into pump outlet.

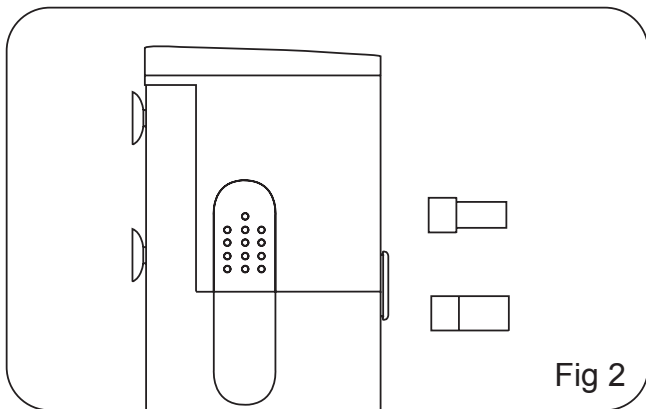

b) If the venturi is required, push venturi outlet directly into pump outlet, hang airline outside of your aquarium.

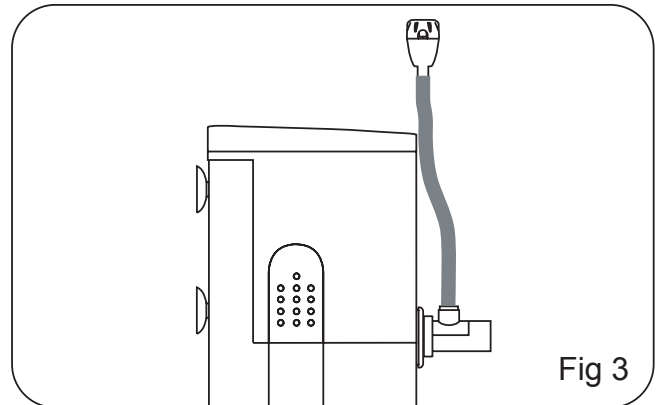

c) If the duckbill is to be used, push duckbill outlet directly into pump.

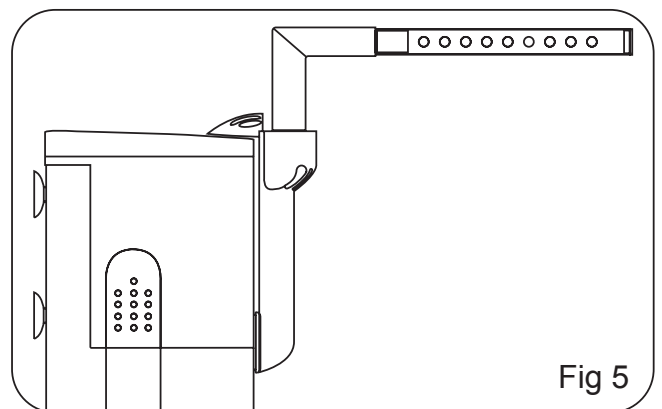
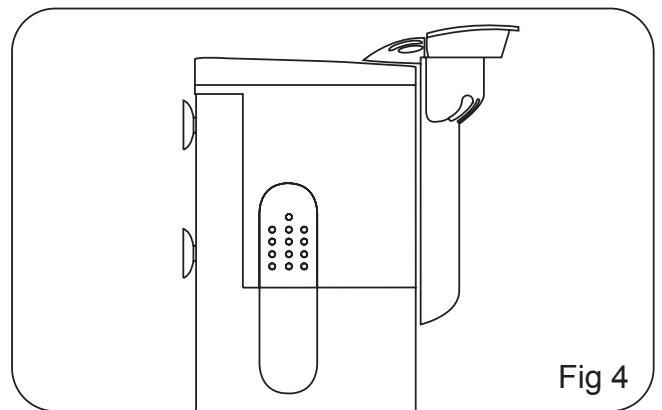

2. Suction cups will fasten the filter to the wall of you aquarium. It is best to have surface agitation if it is being used as the sole filter.

# Maintenance 101/102F

---

1. Unplug from the power supply. Take to sink.
2. Remove the sponge casing from motor to access the filter sponge. (102F has 2)
3. Remove sponge and squeeze gently a few times in a bucket of aquarium water. It is important to not wash the sponge too thoroughly and never wash it in tap water.

If you have a 102F only wash one sponge at a time and rotate them. This will help keep your filter working better.

## Accessing The Impeller

---

Clean the impeller at least once a month.

1. Grasp the motor with one hand and filter casing with the other and gently pull apart.
2. Remove the impeller cover to gain access to the impeller.
3. Pull impeller from the motor and rinse properly. Use an Aqua One double ended pipe brush to clean the impeller and the impeller well and also any of the outlet options that are being used.
4. Put the filter back together and return to the aquarium. Ensure your hand is not wet, plug in at the power supply and turn on.

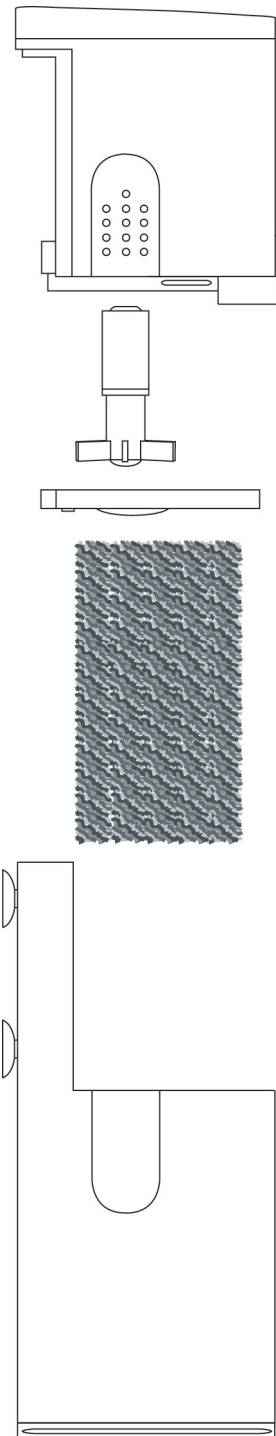

# Know Your Filter 103F & 104F

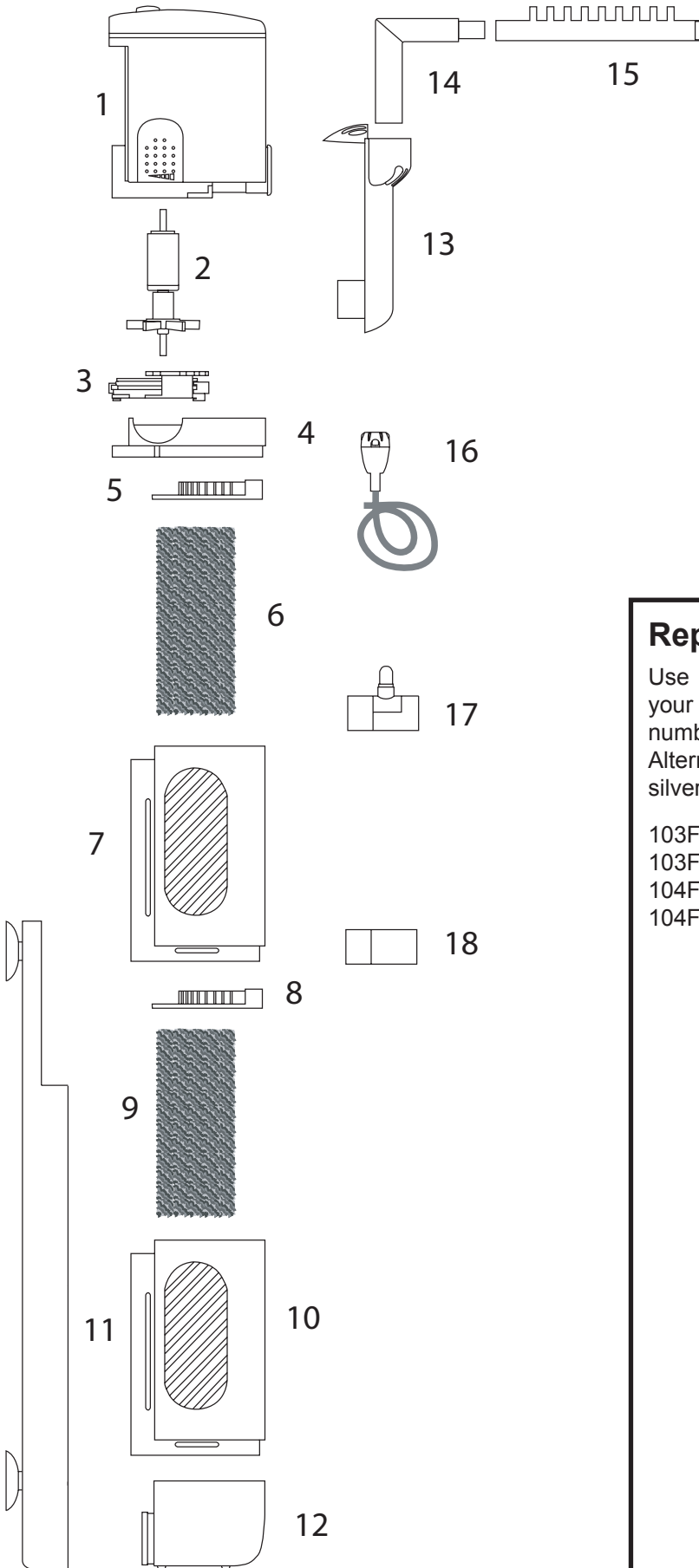

- 1. Motor
- 2. Impeller
- 3. Impeller Cover/ Flow Controller
- 4. Divider
- 5. Sponge Holder
- 6. Sponge
- 7. Sponge Casing
- 8. Sponge Holder
- 9. Sponge
- 10. Sponge Casing
- 11. Mounting Bracket with Suction Caps
- 12. Pre Filter
- 13. Spray bar outlet
- 14. Elbow
- 15. Spray Bar
- 16. Venturi & Air Line
- 17. Venturi Outlet
- 18. 16mm Outlet

## Replacement Parts & Filter Media

Use Aqua One Genuine Spare Parts Only. See your local Aqua One Dealer and look for the number listed below for the spare part you require. Alternatively you will find these numbers on the silver label located on the product.

103F Maxi Sponge	27S
103F Maxi Impeller	27I
104F Maxi Sponge	28S
104F Maxi Impeller	28I

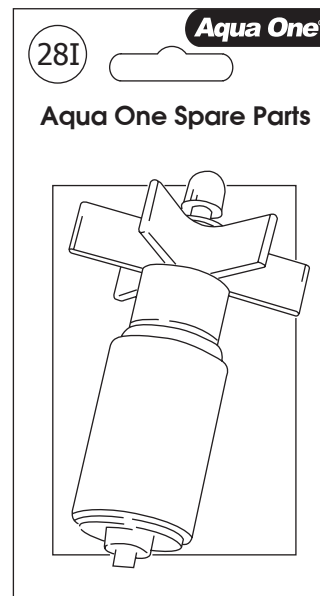

# Installation 103/104F

The larger models have two sponges for additional filtration but still in most cases these models should only be used as a secondary filter to help with existing filtration or as extra water flow in the aquarium.

They are fully assembled and ready to use.

1. Decide on which outlet option to use.

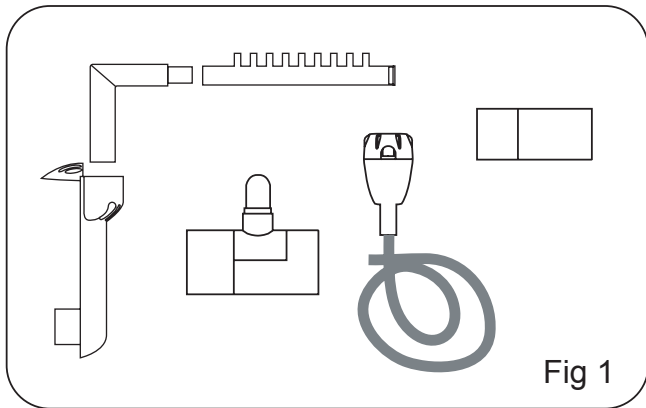

Fig 1

a) If no attachment is required simply push the direct outlet into pump outlet.

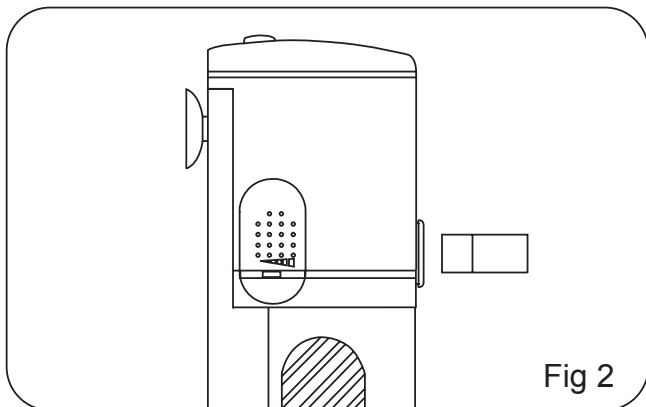

Fig 2

b) If the venturi is required, push venturi outlet directly into pump outlet, hang airline outside your aquarium.

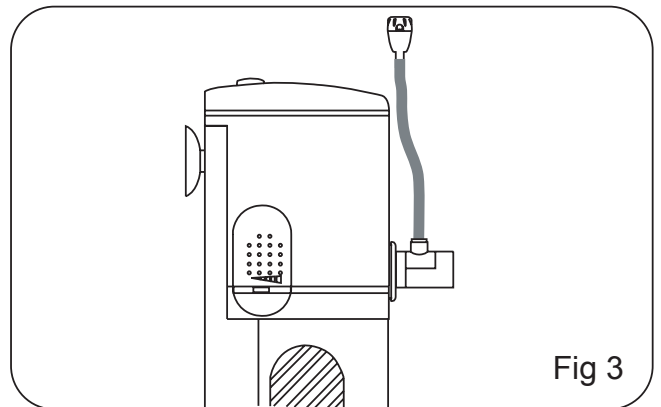

Fig 3

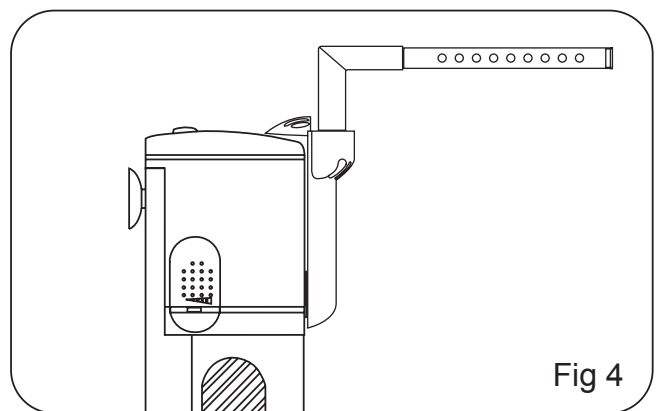

Fig 4

2. Suction cups will fasten the filter to the wall of your aquarium. It is best to have surface agitation if it is being used as the sole filter.

3. Use flow adjuster on the front of the filter:

+ will allow full flow

- will reduce the flow

Remember the more flow the better.

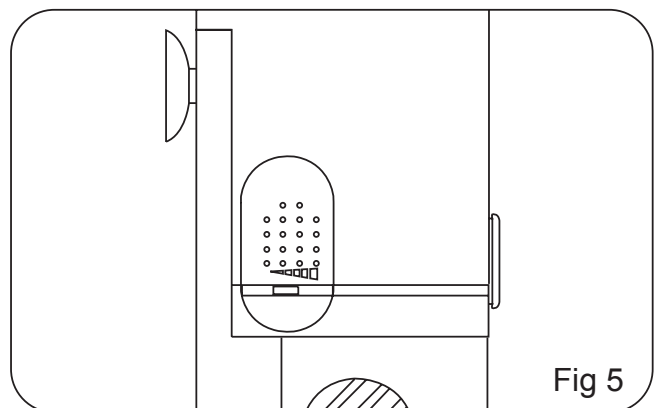

Fig 5



# Maintenance 103/104F

1. Unplug from the power supply. Take to sink.
2. Holding the mounting bracket and sponge casings with one hand and the motor with the other, pull them apart to gain access to the top sponge. Slide the bottom sponge casing out of the mounting bracket along with the pre filter.
3. Remove sponge and squeeze gently a few times in a bucket of aquarium water. It is important not to wash the sponge too thoroughly and never wash it in tap water.

Only wash one sponge at a time and rotate them. This will help keep your filter working better.

## Accessing The Impeller

Clean the impeller at least once a month.

1. Follow step 2 in the maintenance section to gain access to the impeller cover.
2. Turn the impeller cover anti clock wise to gain access to the impeller.
3. Pull impeller from the motor and rinse properly. Use an Aqua One double ended pipe brush to clean the impeller and the impeller well and also any of the outlet options that are being used.
4. Put the filter back together and return to the aquarium. Ensure your hand is not wet, plug in at the power supply and turn on.

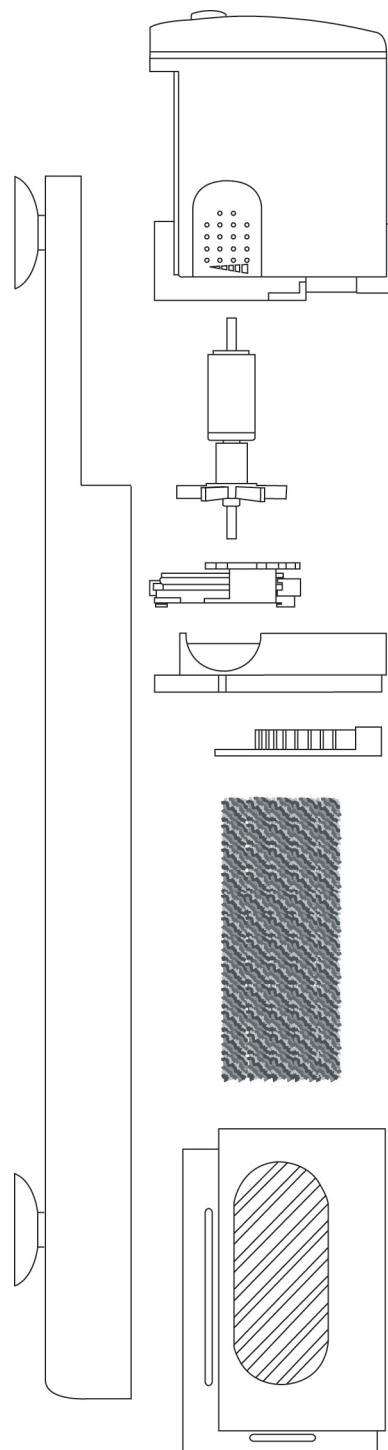

# Aqua One Internal Filter Specifications

## Aqua One 100 Series Maxi Internal Filters 240 V-AC, 50Hz

Model	L/Hr	Dimensions HxWxD	Watt
101F	400	16 x 4.5 x 7 cm	6
102F	500	23 x 4.5 x 8.5 cm	8
103F	1200	28.5 x 6 x 8cm	15
104F	2000	33.5 x 7 x 9cm	30

**Disposal of used Electrical & Electronic Equipment  
(Applicable in the European Union and other  
European countries with separate collection  
systems)**



This symbol on the product or on its packaging indicates that the product must not be disposed of with normal household waste. Instead, it is your responsibility to dispose of your waste equipment by arranging to return it to a designated collection point for the recycling of waste electrical and electronic equipment. By separating and recycling your waste equipment at the time of disposal you will help to conserve natural resources and ensure that the equipment is recycled in a manner that protects human health and the environment. For more information about recycling this product, please contact your local city office, your household waste disposal service or the shop where you have purchased the product.

# Aqua One - Guarantee 2 + 1 Year

Congratulations on your purchase of a quality Aqua One product. This product will last for many years under normal usage the guarantee commences from the day of purchase. You must provide proof of purchase when you submit your equipment for repair under guarantee.

The benefits given to the purchaser by the manufacturers guarantee are in addition to all other rights and remedies which the purchaser has in respect of the equipment under the legislation of the appropriate country of purchase.

Your 2 year guarantee can be extended by a further 1 year upon registration with the distributor. This can be done online at the address below or by completing the extended guarantee registration card and returning by post to the address of your country of purchase.

**[www.aquaone.com.au](http://www.aquaone.com.au)**

1. All claims for guarantee service should be made to the place of purchase.

2. You must provide proof of purchase when you submit your equipment for repair under guarantee.

3. This guarantee extends only to defects occurring in materials or workmanship under normal use of the equipment when operated in accordance with the supplied instructions.

4. Replacement equipment is guaranteed for the remainder of the original manufacturer's guarantee period.

## **5. Guarantee does not cover:**

a. Cost of freight, postage or the cost of insurance.

b. Service costs arising from failure to correctly adjust the controls of the product or to clean the hoses, filter media, impellers, pump heads, failure to observe the manufacturer's instructions or inspections that reveal that the equipment is in normal working order.

c. Equipment failures caused by misuse, neglect, normal wear and tear, accidental breakage, repairs or modification by unauthorised persons, lightning strikes, mains voltage fluctuation, earthquakes, vermin infestation or liquid spillage.

d. Consumables, such as impellers, shafts, filter cartridges, filter media, sponges, wool, light tubes, lamps, bulbs, glass sleeves or starters.

e. In no event will the manufacturer or distributor of that country be liable for any consequential or incidental damage including, but not limited to loss of livestock, property damage, damage to equipment, appliances, furnishings, loss of life, personal injury, lost profits or wages arising from the use of this product or from failure of this product.

f. Damaged incurred in transit resulting from inadequate packing.

6. It is recommended that all equipment subject to claim should be prepared for transportation in its original packaging or other suitable packaging which offers the same degree of protection.



[www.aquaone.com.au](http://www.aquaone.com.au)

® Aqua One is a registered trademark.